



LT33A
CAPACITY
3300 LBS.
1500 Kg.



NOTE: PARTS BREAKDOWN IN THE BACK

1.) Unpackage unit

2.) Attach power unit/handle bracket to base frame, using (6) M10 x 25 HHCS, (6) M10 flat washers, (6) M10 lock nuts & (6) M10 hex nuts. Fig. 1.

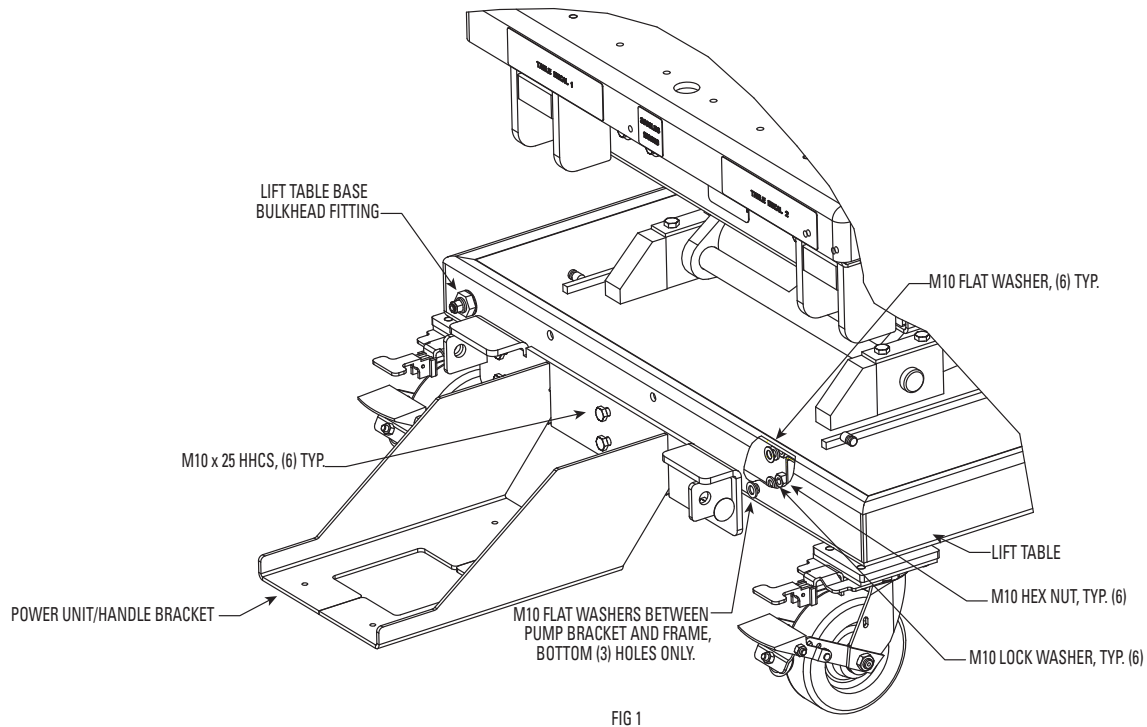

3.) Attach handle to power unit/handle bracket by placing (1) handle pin into the power unit/handle bracket handle hole and then squeezing handle down rods together and inserting the other pin into the other power unit/handle bracket handle hole. After pins have been inserted into holes, place retaining cap over pin, taping into place with a rubber mallet. Lastly, attach springs to the cart spring pin and handle spring pin. Fig. 2.

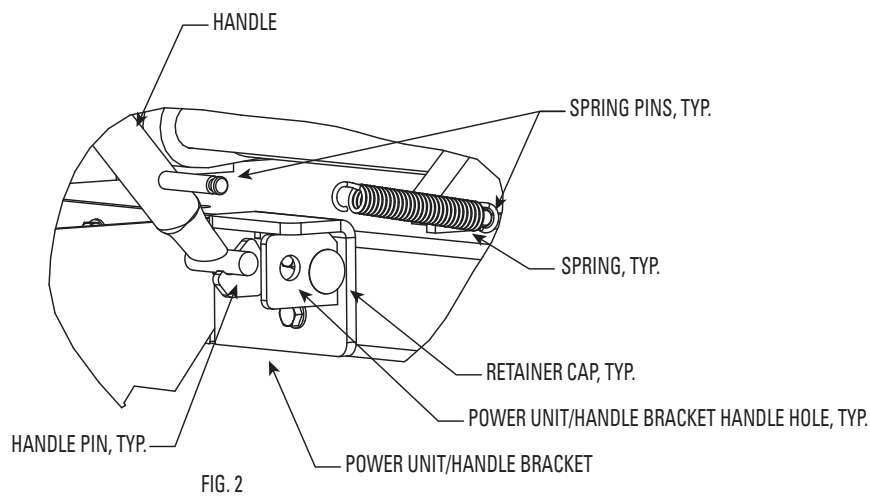

- 4.) Attach Valve bracket using (2) M10 x 12 HHCS. Then attach valve to valve bracket using the handle nut and (1) M4 x 30 PHMS, (1) M4 flat washer & (1) M4 lock nut. Attach 1/4NPT bulkhead to valve bracket and 1/4NPT male coupler to bulkhead just attached. Attach the valve handle to the valve, and lastly attach (1) NP280 to valve bracket, slightly above and to the right of the valve. Fig. 3.

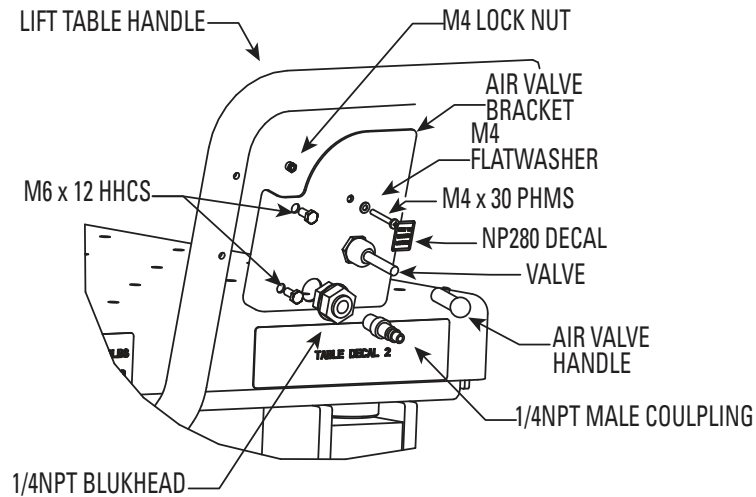

FIG. 3

- 5.) Attach power unit to power unit/handle bracket, aligning the hole pattern on the pump/bracket, by using (4) M6 HHCS, supplied with the pump, and (4) M6 flat washers. Fig. 4.

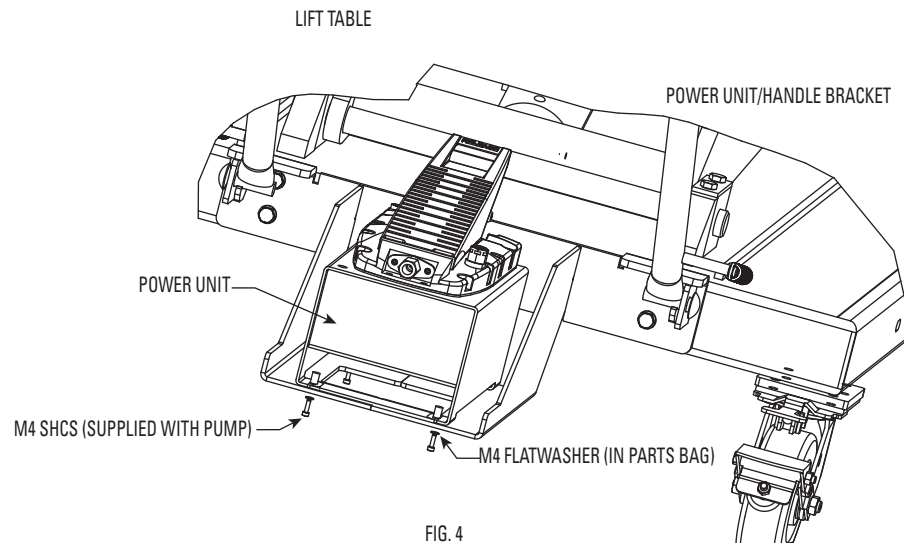
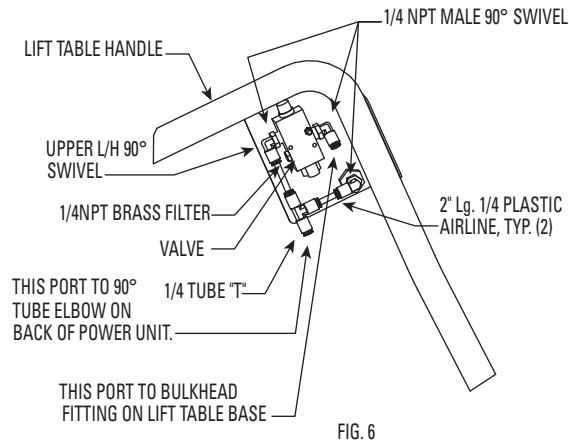
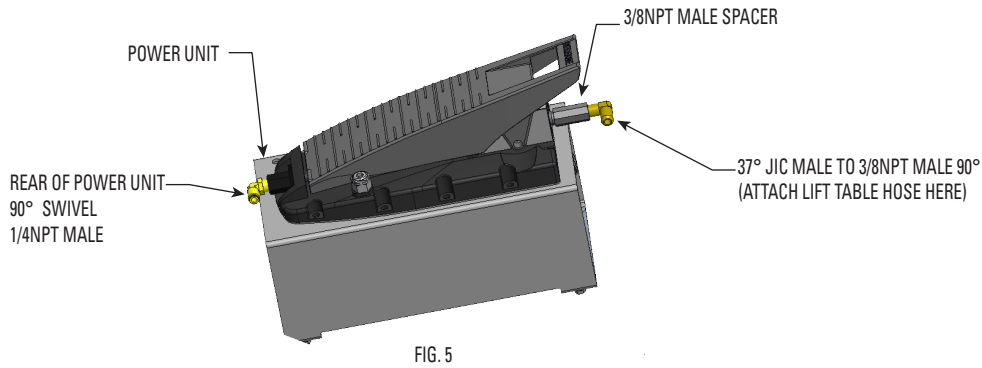

FIG. 4

- 6.) Attach 1/4NPT male 90° swivel fitting to rear of pump. Attach 3/8NPT male to 37° JIC female adapter fitting to front of power unit (under foot pedal). Attach 37° JIC male to 3/8NPT male 90° fitting to adapter fitting just installed. Attach lift table, pre-installed and coiled in table, to 90° fitting just installed. **IMPORTANT:** always use pipe tape/dope on all pipe fittings. Fig. 5.
- 7.) Attach 1/4npt male 90° swivel to the top (2) ports on the air valve. Attach the 1/4NPT male brass filter to the lower left port on the air valve. Attach a 1/4NPT male 90° swivel to the bulkhead fitting. Run ¼ plastic airline, approx. 2" long from the bulkhead swivel 90° and the ¼ tube "T" to the l/h valve swivel 90°. Run ¼ plastic airline from the r/h valve swivel 90° to the bulkhead installed in the lift table base, then run ¼ plastic airline from the open tube port of the ¼ tube "T" to the power unit 1/4npt male 90° swivel (rear port of power unit) routing both airlines down handle, wire tying them to handle approx. every 6" and routing the power unit airline around the front of the power unit, under the hydraulic hose, tying to the hose with a wire tie. **IMPORTANT:** always use pipe tape/dope on all pipe fittings. Fig. 6,5 and 1.



LT33A Operating Instructions Capacity 3300lbs (1500kg)

- 1.) Provide clean dry air to male coupler, 90-120 psi (6-8.3 bar) @ 14 cu.ft/min (400 lpm) max.
- 2.) Place load so center of gravity of load is centered on lift top as close as possible. Note: the sliding end can be slid out to better support load.
- 3.) To help align the lift tabletop with the object being removed/installed in the vehicle, the top can be positively tilted from the rear, or handle side of lift table, 1°, as well as shifted/rotated right to left, by approx. 1" (25mm).
 - a.) To tilt, thread jack screws located at the rear of lift table upward using allen wrench/allen socket until correct angle is met. (Note: lower jack screws when service job is complete), Fig. 1.
 - b.) To shift/rotate table, unlatch red toggle handles on mid table and push/pull "U" shaped handles until desired position is reached. Fig. 2
- 4.) To raise lift table, attach shop airline to male coupling on lift table handle, Fig. 3, then press rear of foot pedal, Fig. 4, on power unit. Raise until desired height is reached.



Fig. 1



Fig. 2

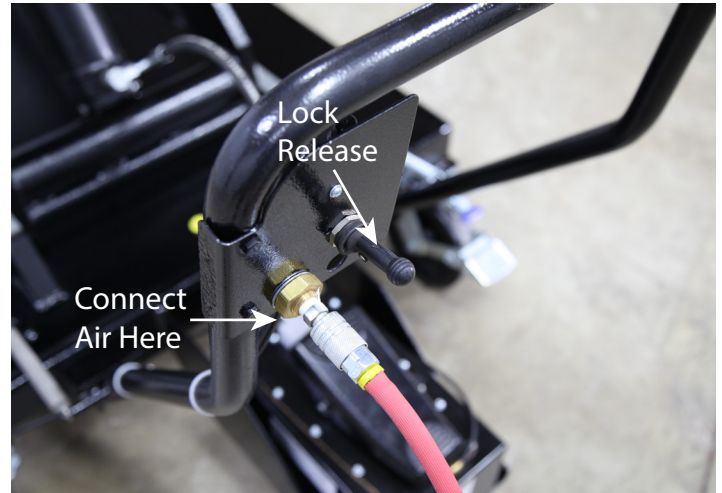

Fig. 3

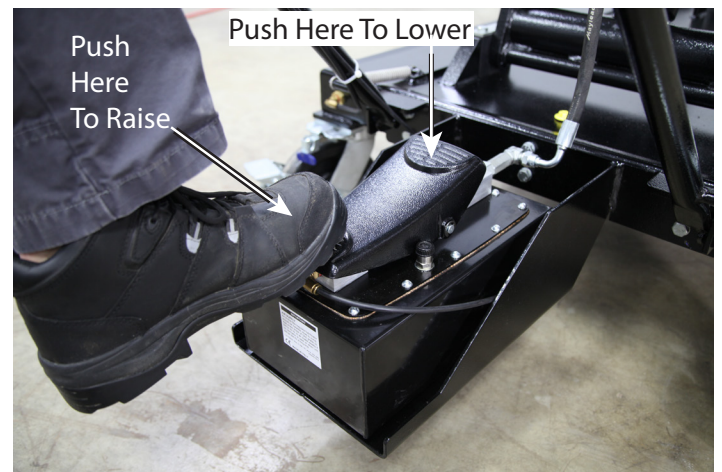

Fig. 4

⚠ WARNING : when raising table be careful not to raise vehicle off lift adapters.



5.) To Lower Table:

- a.) If the lift table is resting in a lock position raise the lift enough to depress the lock handle to clear the locks to lower.

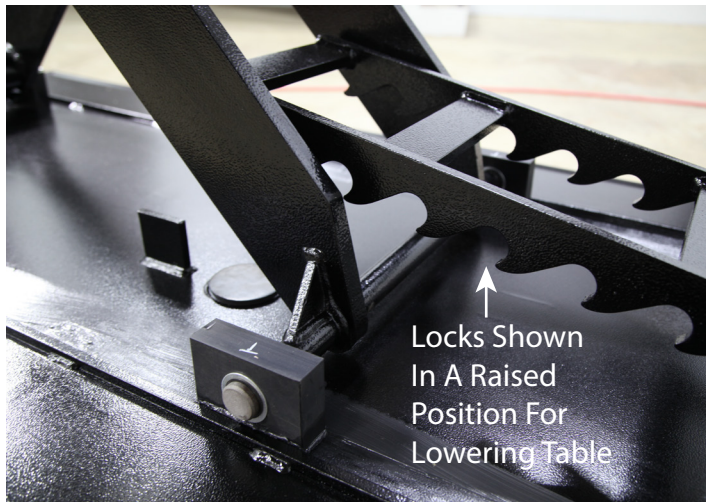

- b.) Depress front of foot pedal on power unit until desired height is reached. Review Figs. 3 and 4.

Note: whenever using lift not in fully lowered position, it is recommended that the nearest lock position be used.

- 6.) When moving the lift table, with or without a load, the casters may be locked directionally by pressing the blue foot tab downward on the caster. For ease of forward/aft movement only lock one front caster rotationally. Additionally, the lift table may be locked into position by pressing the caster locking foot tab downward. Fig. 5

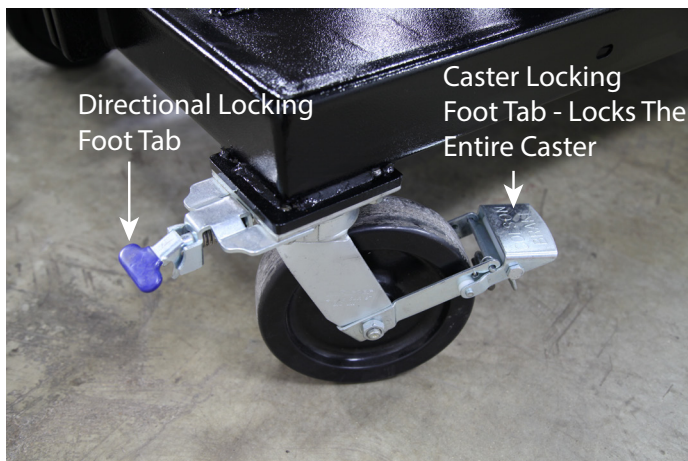

Fig. 5

- 7.) When not in use, store lift table in a clean dry interior area, locking at least (2) casters.

- 8.) Before using the lift table each time check the caster assemblies for debris that may prevent the table from rolling freely. Grease caster assemblies if needed. Check slider blocks and the path of travel to make sure the area is free of debris. Keep well greased, Fig. 6.

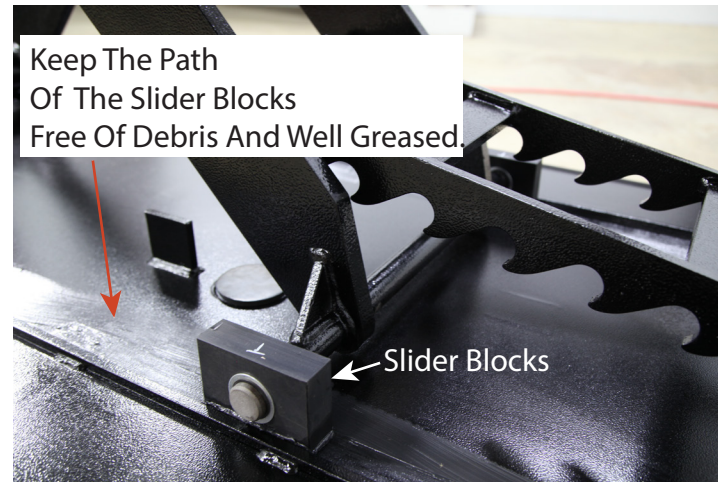
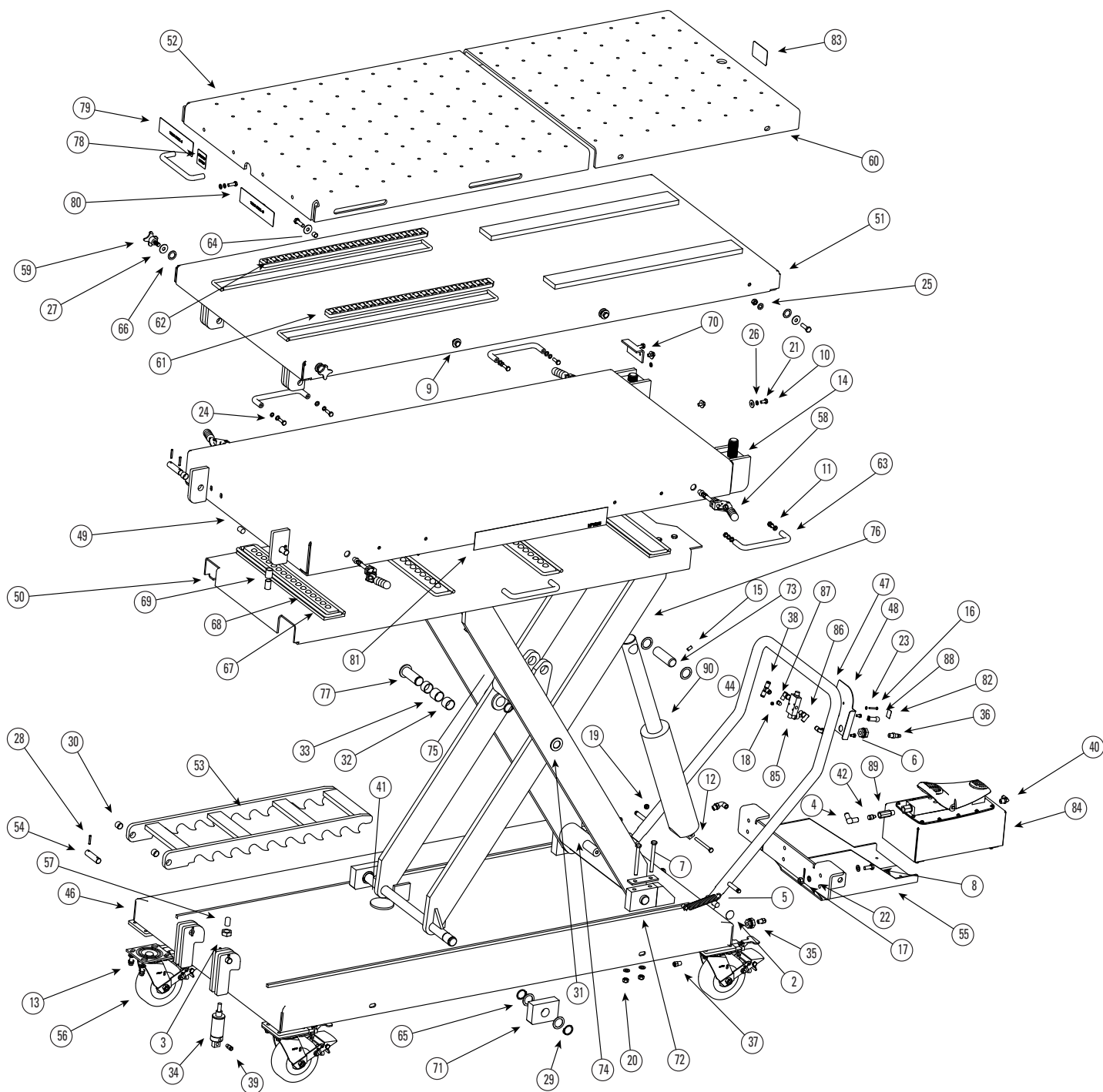
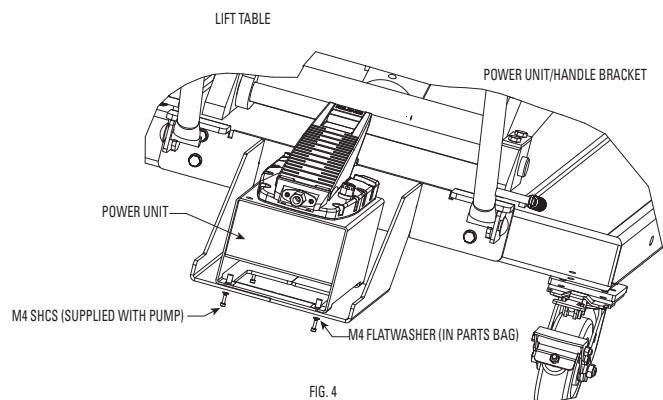

Fig. 6

Check airline routings for any damage and check hydraulic hose/fittings for damage as well. Before lifting vehicle components, raise lift table and listen for, "Click", to make sure locks engage. When lift table is at full height, lower to top lock and inspect structure for any damage/missing parts. If all is well, lower lift table and proceed to vehicle maintenance. If any damage/missing parts, please tag out/lock out and contact Rotary Authorized Repair Services.





65	12	MG12-1007E	ADJUST SHIM
66	4	MG12-1009E	ADJUST SHIM
67	4	MG12-2001E	BALL BRACKET
68	64	MG12-2002E	BALL
69	2	MG12-2003E	PROTECT SPACER
70	2	MG12-2004E	LIMIT BRACKET
71	4	MG12-3001E	MOVEABLE SLIDER
72	4	MG12-3002E	FIXED SLIDER
73	1	MG12-3003E	CYLINDER PIN
74	4	MG12-3004E	SLIDER HOLDER
75	1	MG12-3100E	OUTER LEG WELDMENT
76	1	MG12-3200E	INNER LEG WELDMENT
77	2	MG12-3300E	SHAFT, LEG MIDDLE
78	2	NP1622	3300LB/1500KG CAPACITY NP
79	2	NP1623	LIFT TABLE SAFETY DECAL 1
80	2	NP1624	LIFT TABLE SAFETY DECAL 1
81	2	NP1625	LT33A ROTARY BRANDING DECAL
82	1	NP280	NAMEPLATE
83	1	NP93	NAMEPLATE
84	1	SB700097	CMO PUMP, LIFT TABLE
85	1	T140073	AIR LOCK VALVE
86	2	T140074	ELBOW
87	1	T140075	BRASS FILTER
88	1	T140119	AIR LOCK VALVE HANDLE
89	1	VAS6131-9802-10	3/8" MNPT TO 9/6-18 JIC VALVE HOLDER/ADAPTER
90	1	YG155-9100	LIFT TABLE CYLINDER

Important:
Always make sure decals are legable and replace as needed.

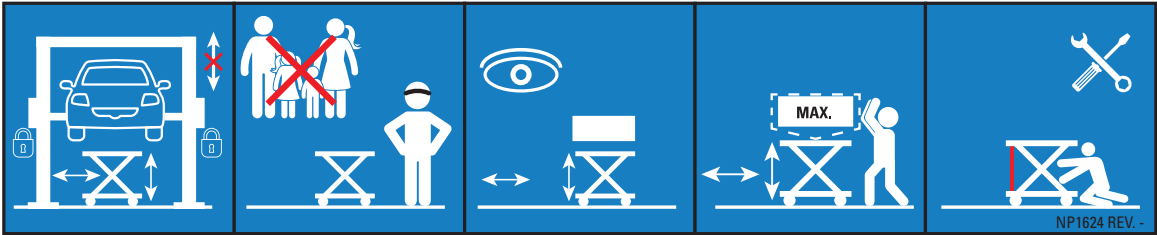
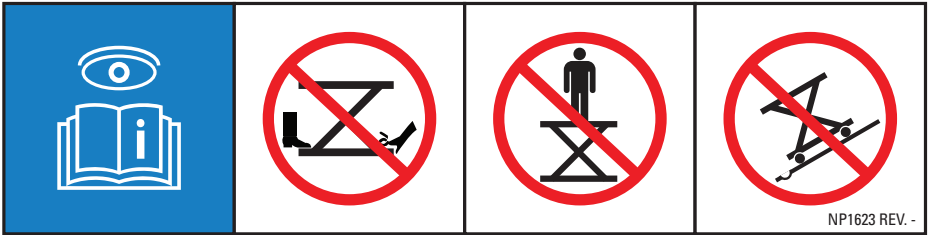

Notes

Notes

Installer: Please return this booklet to literature package, and give to lift owner/operator.

Thank You

Trained Operators and Regular Maintenance Ensures Satisfactory Performance of Your Rotary Products.

Contact Your Nearest Authorized Rotary Parts Distributor for Genuine Rotary Replacement Parts. See Literature Package for Parts Breakdown.

Rotary World Headquarters

2700 Lanier Drive
Madison, IN 47250, USA
www.rotarylif.com

North America Contact Information

Tech. Support:

p 800.445.5438
f 800.578.5438
e userlink@rotarylif.com

Sales:

p 800.640.5438
f 800.578.5438
e userlink@rotarylif.com

World Wide Contact Information

World Headquarters/USA: 1.812.273.1622
Canada: 1.905.812.9920
European Headquarters/Germany: +49.771.9233.0
United Kingdom: +44.178.747.7711
Australasia: +60.3.7660.0285
Latin America / Caribbean: +54.3488.431.608
Middle East / Northern Africa: +49.771.9233.0

© Vehicle Service GroupSM

Printed in U.S.A., All Rights Reserved. Unless otherwise indicated, ROTARY, and all other trademarks are property of Dover Corporation and its affiliates.

